

**감압밸브**  
**직동식**  
**For ANSI 150**  
**JIS 10K-20K**

**직동식 감압밸브**

**일반적으로**

직동식 감압밸브는 컴팩트한 디자인으로 소형 설계로 압력을 조절하여 하류의 압력을 미리 설정된 설정 압력까지 정밀하게 조절하는 것이 특징이며, 혁신적인 설계 덕분에 급격한 압력 변화에 신속하게 대응할 수 있습니다. 직동식 감압밸브는 최대 용량, 빠른 응답 및 정확한 압력 제어를 제공하며, 빠르고 쉬운 유지보수를 위한 최적화된 설계로 총 소유 비용을 최소화할 수 있습니다.

**특징**

- 유지보수가 용이한 최상급 설계
- 감도 증가를 위한 충분한 균형 다이어프램
- 대용량을 위한 전체 포트 설계
- 안정적인 피스톤 가이드 설계
- 모든 압력 차이에서 부드러운 시트로 단단히 차단
- 탁월한 압력 제어 범위성
- 가볍고 컴팩트한 디자인



첨부1. 직동식 감압밸브

**컨트롤 범위:**

- 0.5 to 7 BarG

**온도 범위 :**

- Max. 80°c

**사이즈 :**

- 1/2" ~ 2"

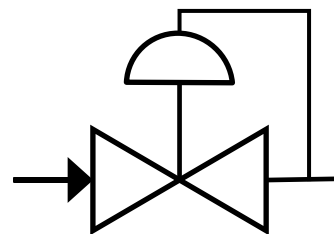

< Downstream Pressure Control >

## 직동식 감압밸브

감압 레귤레이터는 필요한 유체 흐름을 제공하면서 하류의 설계된 압력을 유지합니다.

직동식 레귤레이터는 가장 간단한 형태의 레귤레이터로, 하류의 압력을 감지하여 액츄에이터의 스프링에 의한 압력으로 제어합니다.

### 직동식 감압밸브 사양

Valve Type	Pressure Regulating Valve (Direct Type)					
Valve Model	Series 1207C					
Body Type	Globe					
Trim Type	Balanced					
Valve Size (Inch)	1/2	3/4	1	1-1/4	1-1/2	2
(mm)	15	20	25	32	40	50
Valve Cv	2.1	2.1	3	5.5	8	14
Pressure Rating	ANSI 150Lb , JIS 10K ~ 20K					
Max. Inlet Pressure	20 BarG					
End Connection	RF, FF					
Body Materials	A351CF8					
Trim Materials	Stainless steel					
Bonnet Type	Plain					
Diaphragm Materials	Nitrile (NBR), Fluorocarbon (FKM) and Ethylenepropylene (EPDM)					
Disk Material	Nitrile (NBR), Fluorocarbon (FKM)					

감압밸브 도면

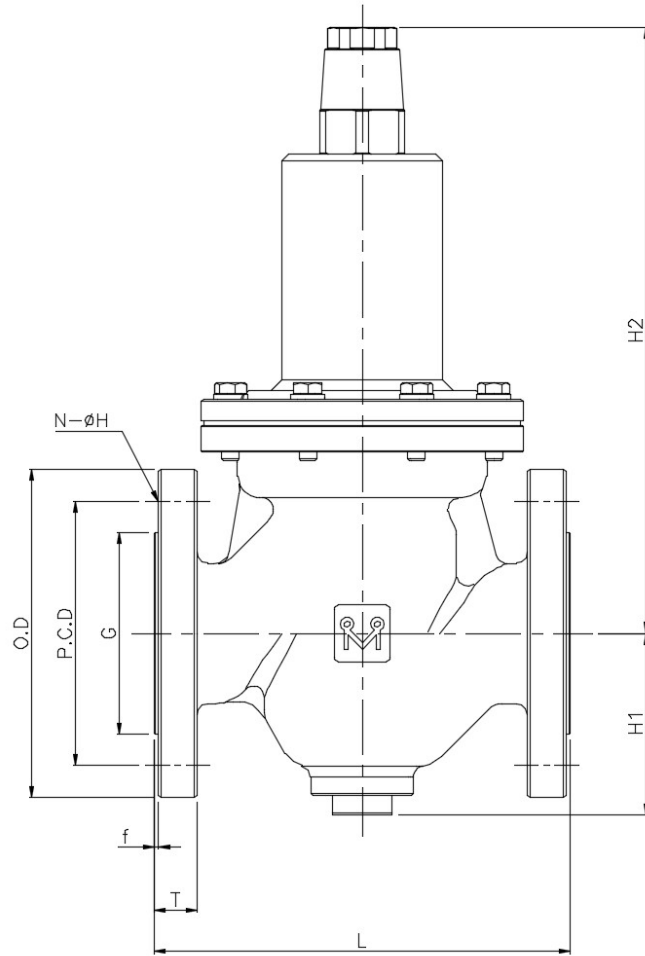

ANSI #150		(UNIT : mm)								
Valve Size	L*	H1	H2	D	P.C.D	G	T	F	N Number of Bolts	H Diameter of Bolt Holes
15 (1/2")	150	50	250	90	60.3	34.9	11.6	2	4	16
20 (3/4")	150	50	250	100	69.9	42.9	13.2	2	4	16
25 (1")	190	63	295	110	79.4	50.8	14.7	2	4	16
32 (1-1/4")	190	83	300	115	88.9	63.5	16.3	2	4	16
40 (1-1/2")	190	83	300	125	98.4	73	17.9	2	4	16
50 (2")	190	83	300	150	120.7	92.1	19.5	2	4	19

\* Face to Face dimension is based on RF flange.

감압밸브 도면

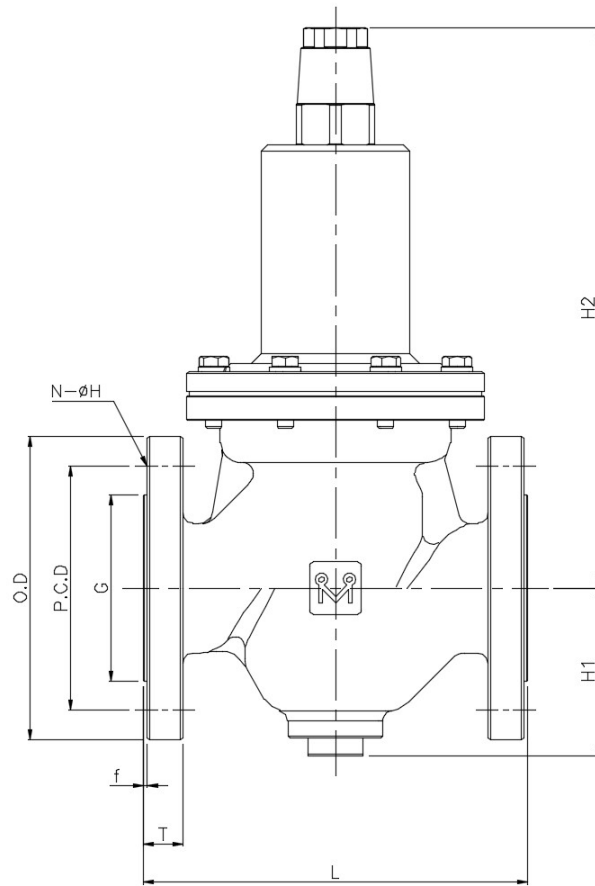

JIS 10K										(UNIT : mm)
Valve Size	L*	H1	H2	D	P.C.D	G	T	F	N Number of Bolts	H Diameter of Bolt Holes
15 (1/2")	150	50	250	95	70	51	12	1	4	15
20 (3/4")	150	50	250	100	75	56	14	1	4	15
25 (1")	190	63	295	125	90	67	14	1	4	19
32 (1-1/4")	190	83	300	135	100	76	16	2	4	19
40 (1-1/2")	190	83	300	140	105	81	16	2	4	19
50 (2")	190	83	300	155	120	96	16	2	4	19

JIS 20K										(UNIT : mm)
Valve Size	L*	H1	H2	D	P.C.D	G	T	F	N Number of Bolts	H Diameter of Bolt Holes
15 (1/2")	150	50	250	95	70	51	14	1	4	15
20 (3/4")	150	50	250	100	75	56	16	1	4	15
25 (1")	190	63	295	125	90	67	16	1	4	19
32 (1-1/4")	190	83	300	135	100	76	18	2	4	19
40 (1-1/2")	190	83	300	140	105	81	18	2	4	19
50 (2")	190	83	300	155	120	96	18	2	8	19

\* Face to Face dimension is based on RF flange.

기본 배관

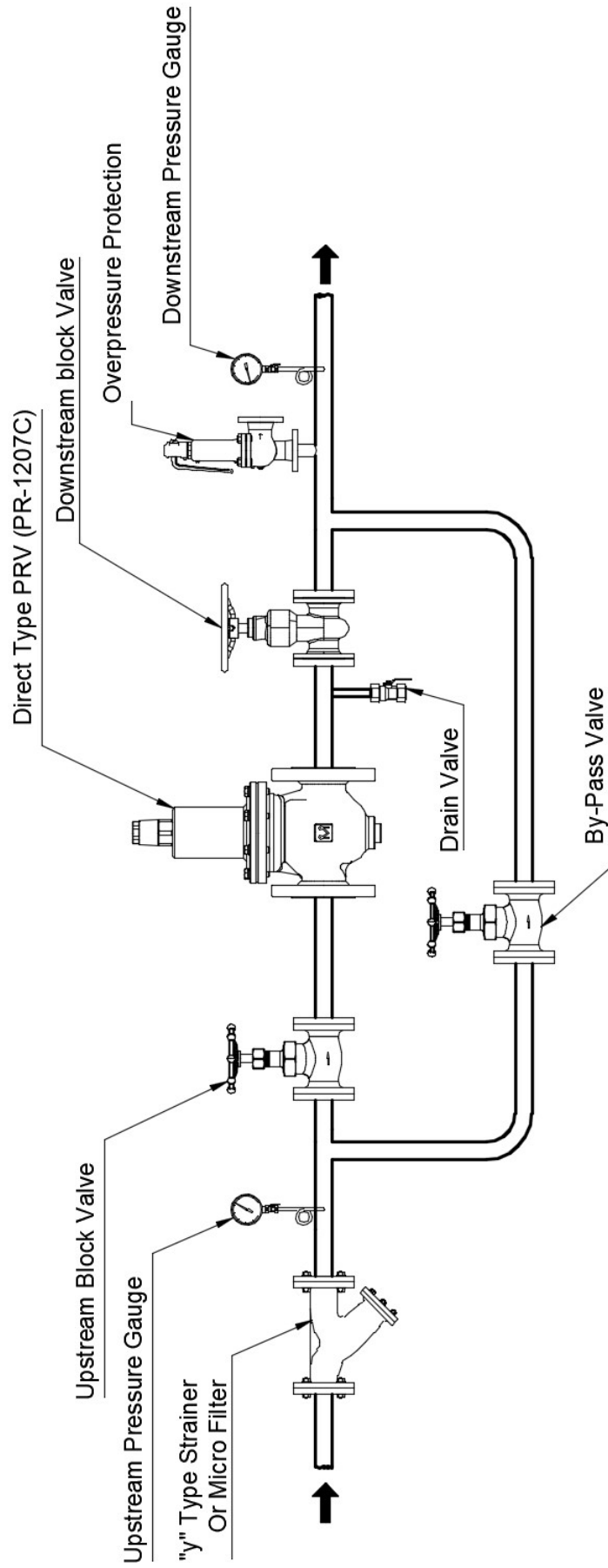

## **Warranty / Remedy**

Doctor Valve Inc. warrants goods of its manufacture as being free of defective materials and faulty workmanship for 12 months from the date of shipment, unless otherwise specified. In this period, all of our products claimed by original defects may be returned to our factory after notice and authorization by us. If warranted goods are returned to Doctor Valve Inc. during the period of coverage, it will be repaired or replaced without charge for those items it finds defective. Such defects shall be exclusive of the effects of corrosion, erosion, normal wear or improper handling and storage. In case our engineers have field service, the user shall detach and install valves by his cost. Determination of the suitability of the Products for the use contemplated by the buyer or buyer's customer(s) is the sole responsibility of the buyer in connection therewith. The foregoing is buyer's sole remedy and is in lieu of all other warranties, expressed or implied, including those of merchantability and fitness for a particular purpose.

**Specifications are subject to change without notices.**



**VALVES & CONTROLS**

Doctor Valve INC.